

PT-D800W 

brother
at your side



Professional Labelling Machine with USB and Wi-Fi Connectivity



- Professional keyboard with integrated graphic backlit LCD
- Wi-Fi connectivity with PC and Mac compatibility
- Prints TZe laminated labels up to 36mm wide
- Advanced cutter creates easy-peel labels in a continuous strip
- Integrated carrying handle and storage area for additional tape cassettes
- Merge text contained in Excel and .csv files to easily batch print many labels at once
- High speed and high resolution printing for crisp text, images and barcodes
- Large 32mm print height for near edge-to-edge printing on TZe labels
- Prints on HSe heat shrink tube up to 17.7mm
- Many built-in label templates for easy label creation
- iOS and Android label design apps available

www.brother.co.za

NEXT TIME

LABEL IT

The PT-D800W is a professional label printer that produces labels up to 36mm in width. Print text, barcodes, images and logos onto laminated, durable labels that are suitable for indoor or outdoor use.

Connect via USB or Wi-Fi to design labels on your PC, Mac, smartphone or tablet using the free label design software and apps available.

P-touch



Optional accessories



PA-BB-003

Battery base for lithium-ion battery



PA-BT-4000LI

Lithium-ion rechargeable battery

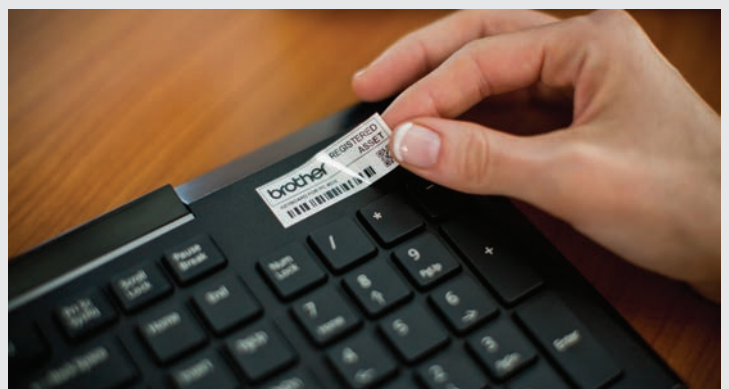



Professional label printing wherever and whenever needed

With a wide range of tape colour combinations and widths, and high speed/high resolution print capabilities, the PT-D800W is ideal for cable marking, facilities management, document archiving, asset labelling and creating on-demand labels whenever and wherever required. Choose from the many built-in label creation options, or use USB or Wi-Fi connectivity to design and print labels from your PC/Mac, or on your iOS/Android smartphone or tablet.

Advanced print engine for fast, efficient labelling

The PT-D800W produces laminated labels from 6mm up to 36mm wide, and with a 32mm print height offers near edge-to-edge printing, minimising the margins around the outside of your labels. The PT-D800W also prints HSe heat shrink tube from 5.8mm to 17.7mm accommodating cable diameters from 1.7mm to 10.6mm.

A print speed of up to 60mm/second dramatically reduces the printing time, which is particularly useful when using the advanced cutter to produce a long strip of labels that are easily peeled one-at-a-time and ensuring that your labels are kept in the correct order.

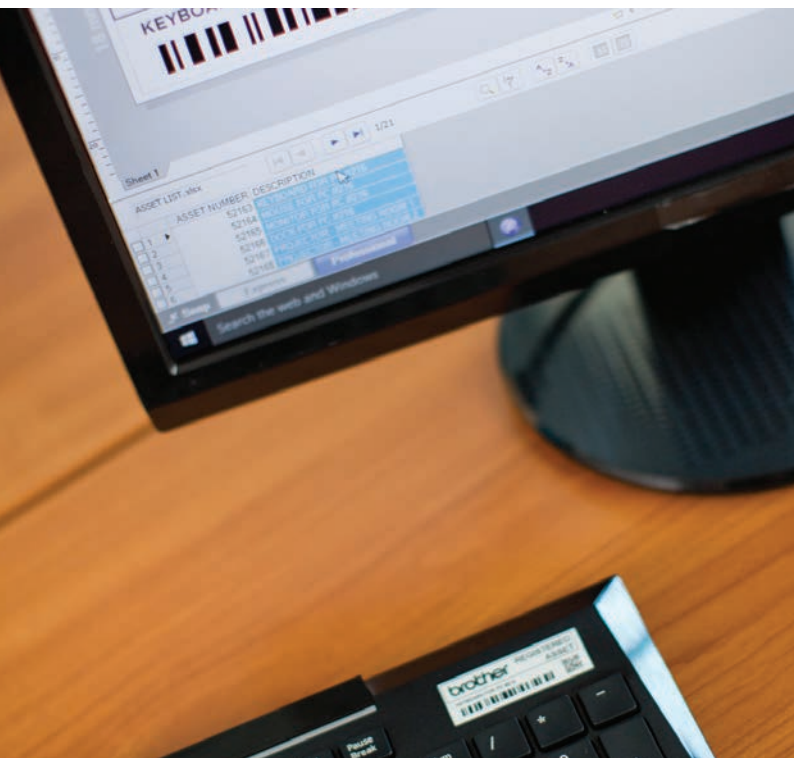

Industrial label design software for PC and Mac

P-touch Editor offers powerful label design software for Windows and Mac. It boasts advanced features normally found in expensive desktop applications such as industry standard 1D and 2D barcodes, importing of logos and other graphics, and allows you to use the fonts installed on your computer. Link to a Microsoft Excel® spreadsheet or a .csv file to print multiple labels quickly and efficiently.

Wireless connectivity and Apps for ultimate flexibility

The PT-D800W can also be connected to your office wireless network, and allow multiple users to print labels from their PC or Mac whenever required.

Create and print labels from your smartphone or tablet quickly without needing to boot your PC or Mac. The Brother **iPrint&Label** app connects wirelessly using Wi-Fi direct allowing you to design simple labels on your iOS or Android device. Or, if you need to identify electrical and data cabling and equipment, use the specialised **Brother Cable Label Tool** app to quickly print labels for wrapping around cables or for sticking to faceplates, electrical distribution boards, cabinets, servers and other equipment.



Store your own label templates and logos for use any time

Create a label design template on your PC, then transfer it to the built-in memory of the PT-D800W. This powerful feature lets you edit the text before printing, ensuring your labels all have the same uniform format. You can also upload your own images such as company logos or specialist symbols for printing away from your PC.

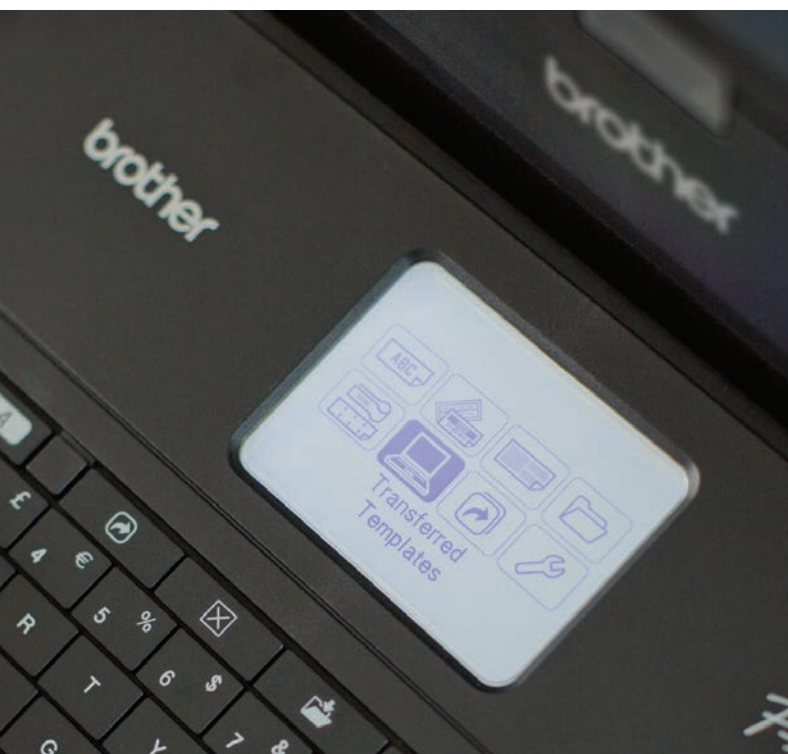

Portable solution to create labels wherever required

Featuring a full-size laptop style keyboard with integrated easy-to-read graphic display, the PT-D800W can be used on-site to instantly create durable labels on demand. Use the many built-in templates, block layouts and hundreds of office and industrial symbols to quickly create labels for any application.

The built-in carrying handle and storage area for tape cassettes and AC adapter means you can easily take the PT-D800W on-site. Attach the optional battery base and rechargeable lithium-ion battery pack to allow label printing wherever and whenever required.



PT-D800W Features / Specifications

Main Features

Prints labels up to 36mm in width | Maximum print height of 32mm for near edge-to-edge printing
Prints on HSe Heat Shrink Tube up to 17.7mm
360dpi print resolution for crisp, legible text, images and barcodes
Fast print speed of 60mm/second
Built-in automatic label cutter with easy-peel function
Minimum label length: 5mm | Maximum label length: 1 metre
Large backlit graphic LCD - 17 characters x 4 lines
Built-in clock to include date/time on your labels
Full size (wired) detachable keyboard with professional PC style keys

Connectivity: Wired

USB: Windows®(USB1.1, 2.0, 3.0 protocol) | Mac (USB 1.0, 2.0 protocol)

Connectivity: Wireless

Wireless Direct: IEEE802.11n | Ad-Hoc mode: IEEE802.11b | Infrastructure mode: IEEE802.11b/g/n | WPS 2.0

Supplied with printer

36mm black on white laminated label cassette (8m)
AC adapter
2 x USB cable (to connect to PC/Mac and to supplied keyboard)
User guide

Tape types supported

TZe tape cassettes: 6mm-36mm
HSe heat-shrink tube: 5.8mm-17.7mm
FLe die-cut labels: 45mm x 12mm

Label creation (using built-in functions)

14 fonts with 12 character styles
99 frames and 465 symbols to further customise your labels
Large text buffer of 1,500 characters per label
99 memory locations to store frequently used labels
35 label auto formats and 32 block layouts to speed up label design
Special functions to create labels for cables, patch panels and faceplates

Label creation (PC/Mac)

Uses P-touch Editor professional label design software
Link to data stored in Microsoft®, Excel® (Windows®) and .csv (Mac) files, to print multiple labels efficiently
Choose any of the fonts installed on your PC/Mac
Supports popular image formats (.bmp, .dib, .jpg, .tif, .ico, .wmf)
Includes hundreds of frames and symbols to customise your labels
Supports industry standard barcode protocols

Label creation (iOS/Android)

Free iPrint&Label app is available for general labelling applications
Free Cable Label Tool app is available for easy labelling of cables, patch panels, faceplates and switches

Barcode protocols supported

1D: CODE39, CODE128, ITF 2/5, EAN13, EAN8, UPC-A, UPC-E, CODABAR, GS1-128 (UCC/EAN128)
2D: QR Code, PDF417, Data Matrix, Aztec Code, RSS-14 (Standard, Truncated, Stacked, StackedOmni), RSS-Limited, RSS Expanded (Standard, Stacked)

Dimensions and weights

337mm (w) x 188mm (d) x 173mm (h) | 3.4kg

System Requirements

Operating Systems: Microsoft® Windows Vista® | Microsoft® Windows® 7 | Microsoft® Windows® 8 | Microsoft® Windows® 8.1
Microsoft® Windows® 10 | Microsoft® Windows Server® 2008 | Microsoft® Windows Server® 2008 R2 | Microsoft® Windows Server® 2012
Microsoft® Windows Server® 2012 R2 | Mac OS X 10.9.5/10.10.x/10.11.x

Hard disk space: Windows®: More than 70MB | Mac: More than 500MB

System memory: As per operating system requirements

Microsoft® Office® support for P-touch add-in:

Microsoft® Word 2007/2010/2013/2016 | Microsoft® Excel® 2007/2010/2013/2016 | Microsoft® Outlook® 2007/2010/2013/2016

Microsoft, Windows, Windows Server and Windows Vista are either registered trademarks or trademarks of Microsoft Corporation in the United States and/or other countries. Apple, Mac, Mac OS, iPhone, iPad and iPod touch are trademarks of Apple Inc., registered in the U.S. and other countries.



brother
at your side

Brother International South Africa

96 Sovereign Drive, Route 21 Corporate Park, Irene
Tel: 0861 BROTHER Fax: +27 (0) 12 - 345 3886

www.brother.co.za <http://solutions.brother.com>



NEXT TIME

LABEL IT



Working with you for a better environment
www.brotherearth.com